

UGJ

Dimensions (mm)	65 x 107
Hight (mm)	28
Max. torque (cNm)	1500
Ratios	4 ^{1/6} ... 36.000.000
Internal slipping clutch	none
Standard shaft (mm)	∅ 12 x 20
Weight (g)	480
Motor combination	Series UB, UD, UF, UH



Standard Data

Mounting	any position
Axial thrust F _A	400 N
Lateral force F _R	600 N
Output shafts	∅ 12 x 20, other on request
Climatic class	wide-spread according to DIN IEC 60721-2-1
Ambient temperature operation	°C -15 ... +55
Ambient temperature storage	°C -40 ... +80

Ratios	4 ^{1/6}	8 ^{1/6}	16 ^{2/6}	33 ^{1/6}	41 ^{2/6}	50	66 ^{2/6}	83 ^{1/6}	100	125	150	166 ^{2/6}	200
	250	500	1000	2000	2500	3000	4000	5000	6250	8333 ^{1/6}	10000	12500	15000
	20000	25000	30000	37500	60000	75000	120000	150000	300000	375000	750000	1500000	1800000
	2250000	3000000	3600000	4500000	6000000	9000000	11250000	12000000	18000000	36000000			

Order Reference

Type	Gearbox	UGJ	100	N	N
Ratio	100				
Slipping clutch	N	Without slipping clutch			
Shaft end	N	∅ 12 x 20, other on request			

Dimensions

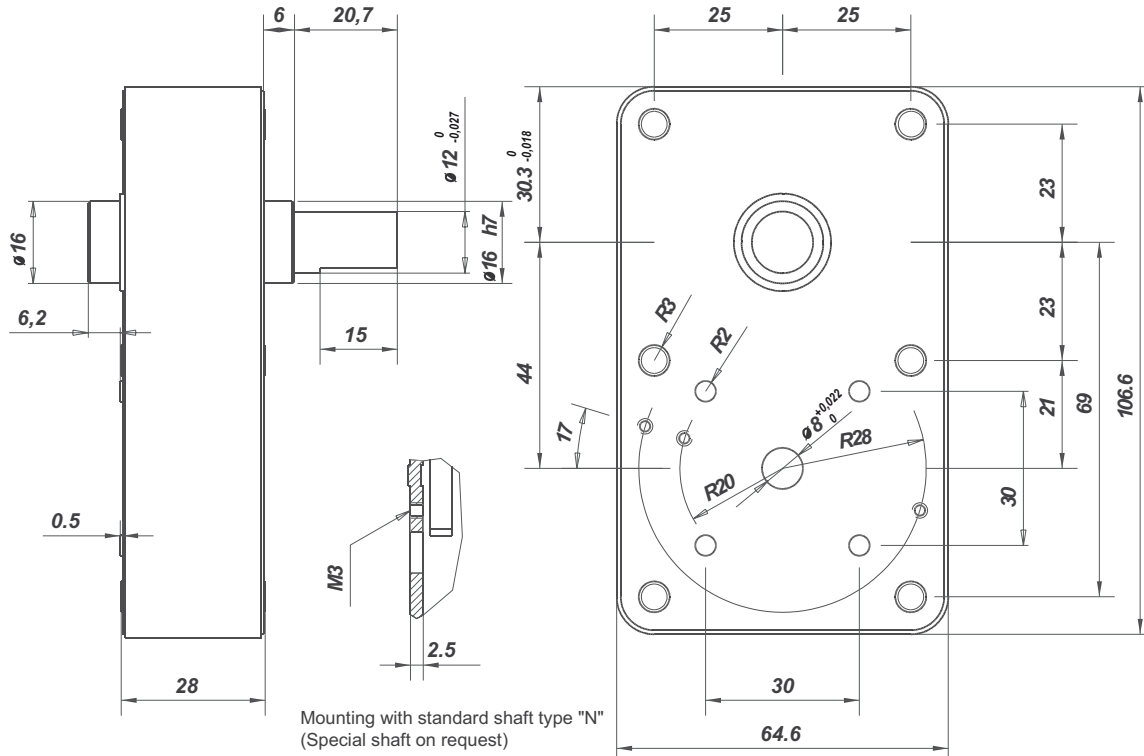

Torque / ratio / life graph

